

2009 Annual Meeting Planning Committee

Rachael Bower | University of Wisconsin-Madison

Sharon Clark | UCAR, NSDL Technical Network Services

Donna Cummings | UCAR, NSDL Resource Center

Anne Diekema | Utah State University

Susan Jesuroga | UCAR, NSDL Resource Center

Lois McLean | McLean Media

Carol Minton Morris | Cornell University

Robert Payo | UCAR, NSDL Resource Center

Lutishoor Salisbury | University of Arkansas

David Yaron | Carnegie Mellon University

Acknowledgements

NSDL would like to thank the National Science Foundation for its generous support and advocacy.

SCHEDULE OVERVIEW

Tuesday, November 17th

TIME	LOCATION	SESSION (TITLE MAY BE ABBREVIATED)
2:00 pm – 5:00 pm	Outside Junior Ballroom	Meeting registration
3:00 pm – 5:00 pm	Junior Ballroom	Poster set up
5:00 pm – 6:00 pm	Junior Ballroom	Opening Plenary
6:00 pm – 8:30 pm	Junior Ballroom	Poster reception

Wednesday, November 18th

7:30 am – 8:30 am	Outside Junior Ballroom	BREAKFAST
8:30 am – 9:45 am	Junior Ballroom	Panel on Cyberlearning
9:45 am – 10:15 am		BREAK
10:15 am – 11:15 am	Room 1	Supporting Social Interaction in the Ensemble Pathway
10:15 am – 11:15 am	Room 2	Best Practices on Collecting and Analyzing Metrics Data
10:15 am – 11:15 am	Room 3	Tales of a Middle School Student Library Design
10:15 am – 11:15 am	Room 3	Personalizing Search
11:15 am – 11:30 am		BREAK
11:30 am – 12:30 pm	Room 1	Open Source Physics Content Delivery
11:30 am – 12:30 pm	Room 1	Conference Services--A Piece of the Sustainability Puzzle
11:30 am – 12:30 pm	Room 2	Diving Into Data: Web Metrics and Educational Data Mining
11:30 am – 12:30 pm	Room 3	The EduPak Software Platform
12:30 pm – 1:30 pm		LUNCH
1:30 pm – 2:30 pm	Room 1	Using Science Literacy Maps
1:30 pm – 2:30 pm	Room 1	Leveraging Across NSDL to Improve Climate Literacy
1:30 pm – 2:30 pm	Room 2	Use and Non-use of Digital Learning Materials: Results of a Survey
1:30 pm – 2:30 pm	Room 2	AMSER and ATE Central: Collaboration with the ATE Community
1:30 pm – 2:30 pm	Room 3	Contributing Collections to NSDL: A How To
2:30 pm – 2:45 pm		BREAK
2:45 pm – 3:45 pm	Room 1	A Journey Into Open Access Publishing Utilizing Open Source Software
2:45 pm – 3:45 pm	Room 1	Trends in Textbook Publishing
2:45 pm – 3:45 pm	Room 2	Critical Trends in K12 Education

2:45 pm – 3:45 pm	Room 3	Metasearch XML Gateway Services for Enhancing Access to STEM Journal
2:45 pm – 3:45 pm	Room 3	Integral: Scalable Digital Library Architecture
3:45 pm – 4:00 pm		BREAK
4:00 pm – 4:30 pm	Room 1	Advanced Distributed Learning Initiatives Update
4:00 pm – 4:30 pm	Room 2	Bridging the Digital Accessibility Gap
4:00 pm – 5:00 pm	Room 3	Creating Science and Math Teacher Leaders—Lessons from Robert Noyce
4:30 pm – 5:30 pm	Room 1	Getting to Know CWIS 2.0
4:30 pm – 5:30 pm	Room 2	Access for All: NSDL Accessibility Portal

Thursday, November 19th

TIME	LOCATION	SESSION (TITLE MAY BE ABBREVIATED)
7:30 am – 8:30 am	Oustide Junior Ballroom	BREAKFAST
7:30 am – 8:30 am	Room 2	BreakFast Roundtable with NSF Officers
8:30 am – 9:30 am	Room 1	Quality Control in DL Content: What Are the Issues?
8:30 am – 9:30 am	Room 1	Alignment for Dummies: How to Refine the Way You Align
8:30 am – 9:30 am	Room 2	Developing an Evaluation Toolkit for Pathways and Other Collections
8:30 am – 9:30 am	Room 2	Implementing User Panels to Evaluate Digital Libraries
8:30 am – 9:30 am	Room 3	Lightning Talks
9:30 am – 9:40 am		BREAK
9:40 am – 10:40 am	Room 1	CPALMS: Florida's Curriculum Planning and Learning Management System
9:40 am – 10:40 am	Room 1	Activities and Lessons Learned from the SMILE Pathway
9:40 am – 10:40 am	Room 2	Implementing Web 2.0 Functionalities on NSDL Portals
9:40 am – 10:40 am	Room 2	Qualitative Research with Middle School Students on Technology Design
9:40 am – 10:40 am	Room 3	ASN Toolkit: Linking Cyber Learning Systems Through Achievement Standards
9:40 am – 10:40 am	Room 3	Automated Metadata Generation
10:40 am – 10:50 am		BREAK
10:50 am – 11:50 am	Room 1	Recommender Systems, Contextualization and Personalization in NSDL
10:50 am – 11:50 am	Room 2	Open Educational STEM Resources in the Middle School
10:50 am – 11:50 am	Room 2	The Math Images Project
10:50 am – 11:50 am	Room 3	Science Pipes in the Classroom: Plumbing the Depths of Biodiversity
10:50 am – 11:50 am	Room 3	IsoverDL: Exploring a Sustainable Digital Library Using SaaS and Open Source
11:50 am – 12:15 pm		BREAK
12:15 pm – 1:00 pm	Junior Ballroom	LUNCH
12:15 pm – 1:00 pm	Junior Ballroom	Closing Remarks: Ithaka Case Studies in Sustainability
1:00pm		ADJOURN

What you need to know

All the meeting events will be held at the Washington Marriott at Metro Center
775 12th Street NW | Washington, DC 20005 | 202-737-2200

Posters

The Junior Ballroom will be open for viewing posters and networking with colleagues at the poster reception on Tuesday from 6:00pm – 8:30pm. Hors d'oeuvres, meeting tables, and wireless Internet access will be provided. Posters will remain in the Junior Ballroom for the duration of the meeting with tear down on Thursday at 1:00pm.

Schedule Notes

Schedule information is included in this program and in your meeting packet, including a list of Lightning Talks and poster abstracts. For additional information go to: http://nsdlnetwork.org/annual_meeting

Tracking the Conference

Commentary ▶▶ Twitter

We invite all attendees to comment about the meeting and sessions on Twitter by adding a “#nsdl2009” hashtag to your tweets.
<http://search.twitter.com/search?q=%23nsdl2009>

Photos ▶▶ Flickr

If you upload photos from the 2009 Annual Meeting to Flickr, you can tag them with ‘nsdl2009.’ <http://www.flickr.com/photos/tags/nsdl2009>

Presentation Sharing ▶▶ Slideshare

If you share your presentations from the 2009 Annual Meeting, you can tag them with ‘nsdl2009.’ <http://www.flickr.com/photos/tags/nsdl2009>

Social Bookmarking ▶▶ Diigo

Discovered great websites and tools at the meeting? Share them on Diigo by tagging them with ‘nsdl2009.’ <http://www.diigo.com/tag/nsdl2009?tab=153>

Social Bookmarking ▶▶ Delicious

Delicious is another social bookmarking tool that you can use to share websites that you discovered at the 2009 NSDL Annual Meeting. Tag your resources with ‘nsdl2009.’ <http://delicious.com/tag/nsdl2009>

NSDL Contacts

National Science Foundation

Lee Zia, NSDL Program Officer

Hal Richtol, NSDL Program Officer

Dave McArthur, Evaluation Consultant

NSDL Resource Center

Kaye Howe, (PI) Director

Susan Van Gundy, (Co-PI) Deputy Director

Mary Marlino, (Co-PI) Evaluation

NSDL Technical Network Services

Carl Lagoze, (PI) Cornell University

Tamara Sumner, (Co-PI) University of Colorado-Boulder

Mike Wright (Co-PI) Digital Learning Sciences

Karon Kelly, Director, Digital Learning Sciences

NOVEMBER 17

TUESDAY

Washington Marriott at Metro Center

2:00 pm – 5:00 pm **Outside Junior Ballroom**
Meeting Registration

3:00 pm – 5:00 pm **Junior Ballroom**
Poster Set-Up

5:00 pm – 6:00 pm **Junior Ballroom**
Opening Plenary

Welcome

Susan Jesuroga, Annual Meeting Chair

Opening Remarks

Hal Richtol, NSDL Program Officer, National Science Foundation

Kaye Howe, NSDL Resource Center

Carl Lagoze, NSDL Technical Network Services

Linda Slakey, Director, Division of Undergraduate Education, National Science Foundation

6:00 pm – 8:30 pm **Junior Ballroom**
Poster Reception

NOVEMBER 18

WEDNESDAY

Washington Marriott at Metro Center

7:30 am – 8:30 am

Outside Junior Ballroom

BREAKFAST

8:30 am – 9:45 am

Junior Ballroom

Panel on Cyberlearning: Fostering Learning in a Technology-Enriched World

Susan Jesuroga, Moderator

Arlene De Strulle (NSF), Bruce Mason, Kimberly Lightle, Cathy Manduca,
Darrell Porcello

Delve into the realities of cyberlearning, as this panel provides insights to help the NSDL community unpack the definition of cyberlearning and discusses how cyberlearning can contribute to different STEM education communities.

9:45 am – 10:15 am

BREAK

10:15 am – 11:15 am

Room 1

Supporting Social Interaction in the Ensemble Pathway

Lillian Cassel, Lois Delcambre, Ed Fox, Rick Furuta, Peter Brusilovsky

The Ensemble site can be described as a community center, and this presentation will illustrate the use of Drupal, Second Life, Facebook and some custom tools for supporting social groupings of computing education collaborators.

10:15 am – 11:15 am **Room 2**

Best Practices on Collecting and Analyzing Metrics Data to Support a Comprehensive Project-Level Evaluation Strategy

Kimberly Lightle, Ed Almasy, Lyle Barbato, Sharon Clark, Yolanda George, Sherry Hsi, Cathy Lowe, Paul Mackinney, Eileen McIlvain

The NSDL Metrics Working Group will report on efforts and share resources to help projects correlate activities, metrics data, and impact.

10:15 am – 11:15 am **Room 3**

Tales of a Middle School Student Library Design Team

Sarita Pillai

This session will showcase a series of math/science virtual learning experiences, for audience feedback, designed with a student co-design team as part of the Middle School Portal 2 project.

Personalizing Search

Anne Diekema, Lynne Davis

Come see why the process of resource discovery in digital libraries needs to be molded to allow personal and social information management to improve usability and library effectiveness.

11:15 am – 11:30 am **BREAK**

11:30 am – 12:30 pm **Room 1**

Open Source Physics Content Delivery: Computation, Curriculum and Libraries

Bruce Mason

This talk showcases the use and dissemination of computational models using the Open Source Physics library, the Easy Java Simulations modeling environment, and the ComPADRE Pathway.

Conference Services – A Piece of the Sustainability Puzzle

Lyle Barbato, Bruce Mason

Hear about the role of conference services in topical digital libraries and the sustainability model ComPADRE has adopted for providing such services.

11:30 am – 12:30 pm **Room 2**

Diving into Data: Web Metrics and Educational Data Mining to Evaluate Digital Libraries

Sherry Hsi, mimi recker, Bob Donahue

Drawing from the Instructional Architect and Exploratorium Learning Resources Collection, learn how to use web metrics and educational data mining to infer impact.

11:30 am – 12:30 pm **Room 3**

The EduPak Software Platform

John Weatherly, Jim Blake, Kimberly Lightle, Jonathon Ostwald, Darrell Porcello

This panel will describe EduPak, the NSDL platform for building digital collections and rich learning applications, featuring examples of use from NSDL projects.

12:30 pm – 1:30 pm

LUNCH

Outside Junior Ballroom

1:30 pm – 2:30 pm **Room 1**

Using Science Literacy Maps

Ted Willard, John Weatherly

From the people who brought you the Science Literacy Maps, an overview of how to use them to improve the coherence of your curriculum and identify resources.

Leveraging Across NSDL to Improve Climate Literacy and Energy Awareness

Tamara Ledley, Mark McCaffrey, Kimberly Lightle, Ted Sicker, Joel Rosenberg

The Climate Literacy and Energy Awareness Network (CLEAN) Pathway project members will explore with other NSDL Pathway and Collection projects opportunities to leverage resources and community engagement mechanisms for the benefit of NSDL.

1:30 pm – 2:30 pm**Room 2****Use and Non-use of Digital Learning Materials: Results of a Survey of Physics Faculty**

Glenda Morgan, Bruce Mason, Flora McMartin, Josh Morrill, Ellen Iverson, Alan Wolf

Learn about the results of a survey of physics faculty members and teachers conducted in collaboration with ComPADRE and the American Association of Physics Teachers and what they tell us about the use of digital resources and how patterns of usage vary across a number of demographic characteristics.

AMSER and ATE Central: Collaboration with the ATE Community

Rachael Bower, Ed Almasy

This session will provide an overview of the ATE Central project which grew out of collaboration between AMSER and the ATE (Advanced Technological Education) community.

1:30 pm – 2:30 pm**Room 3****Contributing Collections to NSDL: A How To**

Katy Ginger, Tim Cornwell, Laura Lusk

Gain an understanding of the new focus of the NSDL collection, tools and methods for accessioning collections and tips for creating quality metadata.

2:30 pm – 2:45 pm**BREAK****2:45 pm – 3:45 pm****Room 1****A Journey into Open Access Publishing Utilizing Open Source Software**

Amy Chang, Kelly Gull, KaRyn Daley, Michelle Slone

Hear how open source publishing software has enabled the American Society for Microbiology's *Journal of Microbiology & Biology Education* to become open access after 3 years of subscriptions.

Trends in Textbook Publishing

Mike Luby

Open discussion concerning recent trends in college textbook publishing and how these developments might present opportunities for Pathways and NSDL in general.

2:45 pm – 3:45 pm **Room 2**
Critical Trends in K12 Education

Laurie Smith, Susan Van Gundy

Find out the latest trends in K12 education, examined through several specific lenses: Project Tomorrow's data surveys, and exploring how students comprise a "Digital Advance Team"; the 21st Century Skills Map for Science, and how NSDL can support educators in effecting its recommendations; and discussion of the emerging need for, challenges to, and implications for K12 education.

2:45 pm – 3:45 pm **Room 3**
Metasearch XML Gateway Services for Enhancing Access to the STEM Journal Literature

William Mischo, Josh Bishoff

The University of Illinois at Urbana-Champaign Libraries has developed and implemented several metasearch-based services to enhance access to and visibility of STEM journal literature and to complement the NSDL.org repository content.

Integral: Scalable Digital Library Architecture

Min Song, Mary Ho

Learn about Integral, a flexible, scalable architecture for digital libraries and its approach for automatically linking related information and services throughout and across these online repositories.

3:45 pm – 4:00 pm **BREAK**

4:00 pm – 4:30 pm **Room 1**
Advanced Distributed Learning Initiative Update

Paul Jesukiewicz

The Director of the Advanced Distributed Learning (ADL) initiative will update the NSDL community on ADL activities and roadmap including SCORM, CORDRA and registries.

4:00 pm – 4:30 pm **Room 2**
Bridging the Digital Accessibility Gap

K. Selcuk Candan

Learn about “Middleware for Accessible Information Spaces on NSDL (MAISON)”, which aims to improve participation in NSDL of teachers, librarians, and learners who are blind by implementing open web-based service APIs for implementing navigation interfaces that reduce the complexity of the information space and provide previews to prevent user disorientation.

4:00 pm – 5:00 pm **Room 3**
Creating Science and Math Teacher-Leaders Who REALLY Use Digital Resources: Lessons Learned from Working with Robert Noyce Scholars

David Andrews, Jaime Arvizu, Elizabeth Ambos, Jennifer Bradford, Frank Garcia, Chris Borquez, Laura Henriques, Meredith Ashbran, Sara Meadows

Over the last two years, our “Building Locally-Linking Globally” project has educated and empowered more than 100 Robert Noyce Scholars in the use of NSDL, MERLOT, and ePortfolio resources and tools. Several of these educators will share their teaching approaches, particular with respect to learning gains achieved through these resources in high-needs classrooms.

4:30 pm – 5:30 pm **Room 1**
Getting to Know CWIS 2.0

Ed Almasy, Rachael Bower

This hands-on workshop will provide participants with an overview of Scout’s open source portal software, CWIS. Handouts and individual CWIS installations will be provided.

4:30 pm – 5:30 pm **Room 2**
Access for All: NSDL Accessibility Portal

Madeleine Rothberg, Peter Pinch, Joel Rosenberg

WGBH is building an accessibility portal for NSDL. In this hands-on session, try accessibility tools in Teachers’ Domain and SMILE and learn how to integrate your collection.

NOVEMBER 19

THURSDAY

Washington Marriott at Metro Center

7:30 am – 8:30 am

BREAKFAST

Outside Junior Ballroom

7:30 am – 8:30 am

Room 2

Breakfast round table with NSF Officers

Come and talk with NSF officers about sustainability and other concerns of established collections and services.

8:30 am – 9:30 am

Room 1

Quality Control in DL Content: What Are the Issues?

Marsha Matyas

Learn about strategies used by BEN libraries to assure quality of resources (e.g., scientific accuracy, safety, use of organisms in teaching) by establishing standards and review processes.

Alignment for Dummies: How to Refine the Way You Align

Ted Willard, Francis Molina

Project 2061 has provided guidance to NSDL projects on aligning resources to K-12 education standards. We share some of our best practices in this session.

8:30 am – 9:30 am **Room 2****Developing an Evaluation Toolkit for Pathways and Other Collections**

Glenda Morgan, Flora McMartin, John Morrill, Ellen Iverson, Alan Wolf

Gain insights on the process of transforming a survey, from a nation-wide study of how faculty use digital learning resources, into an instrument that can be used by others to do their own evaluations and studies.

Implementing User Panels to Evaluate Digital Libraries

Flora McMartin, Josh Morrill

In this presentation, we will describe User Panels as a method for evaluating digital libraries, which is longitudinal in nature and allows for study of behaviors and attitudes over time.

8:30 am – 9:30 am **Room 3****Lightning Talks**

mimi recker, Kimberly Lightle, Sherry Hsi, Darrell Porcello, Lois McLean, Ed Almasy, Sam Donovan, Bruce Mason, Min Song, K. Selcuk Candan, Anne Diekema

Hear about the latest project results from a variety of speakers in the NSDL community.

9:30 am – 9:40 am**BREAK****9:40 am – 10:40 am** **Room 1****CPALMS: Florida's Curriculum Planning and Learning Management System for Teachers Putting Standards into Practice**

Danielle Sherdan, Rabieh Razzouk, Kimberly Lanier

CPALMS: an intuitive and customizable web-based portal that integrates professional support tools and high-quality instructional resources aligned to Florida's standards.

Activities and Lessons Learned from SMILE Pathway

Darrell Porcello, Sherry Hsi, Joel Rosenberg

Learn soup-to-nuts on how the Science Mathematics Informal Learning Educator's team created a Pathway through the customization of readily available tools.

9:40 am – 10:40 am **Room 2**
Implementing Web 2.0 Functionalities on NSDL Portals

Daniella Quinones, Ted Sicker, Kimberly Lightle, Robert Payo

Learn how various NSDL portals are using web 2.0 functionalities to provide environments for participation from and among end users.

Qualitative Research with Middle School Students on Technology Design, Uses and Preferences

Sarita Pillai, Kimberly Lucas

Hear about the results of qualitative research activities (focus groups and a 1000+ person survey) with middle school students in the design of virtual learning experiences for youth as part of the Middle School Portal 2 project.

9:40 am – 10:40 am **Room 3**
ASN Toolkit: Linking Cyber Learning Systems through Achievement Standards

Diny Golder, Jillian Dellit

The Achievement Standards Network (ASN) Toolkit pulls together Web-based services to facilitate a cataloger's efforts in generating metadata and correlating NSDL resources to achievement standards.

Automated Metadata Generation

Robby Robson

See a demonstration and details of machine generation of metadata for documents and text streams, and find out about applications available to digital libraries.

10:40 am – 10:50 am **BREAK**

10:50 am – 11:50 am Room 1

**Recommender Systems, Contextualization and Personalization in NSDL:
Current and Future Research Directions**

Keith Maul, Brett Shelton, Joel Duffin, mimi recker, Frank Shipman, Todd Will

Recommender systems provide a host of new techniques and technologies for enhancing the value and utility of digital library resources. This panel will explore several ongoing recommender system projects within NSDL and examine future collaborations and opportunities.

10:50 am – 11:50 am Room 2

Open Educational STEM Resources in the Middle School

Christine Loew, Kimberly Lightle, Mary Henton, Anne Schreiber, Peter Levy

In today's restrictive budget environment school districts are seeking out new innovative options to providing high-quality STEM curriculum. Curriki and the MSP2 project provide a vision for the future that advances free and open educational resources.

The Math Images Project

Gene Klotz

The Math Images Project is a digital library of potential broad interest, as well as our method of production, which is of considerable educational value as well.

10:50 am – 11:50 am Room 3

Science Pipes in the Classroom: Plumbing the Depths of Biodiversity

Will Morris, Courtney Wilson

Try out Science Pipes for user-friendly analysis of large datasets and see its application in student investigations of Amazonian biodiversity.

**IsoveraDL: Exploring a Sustainable Digital Library using SaaS and Open
Source Software**

Shakib Mostafa, Cal Collins, Susan Musante

Panel discussion on how organizations can maintain sustainable digital libraries in a cost effective way using the SaaS offering of the Open Source IsoveraDL Collections Tool.

11:50 am – 12:15 pm**BREAK****12:15 pm – 1:00 pm****LUNCH****Junior Ballroom**

Closing Plenary**Ithaka Case Studies in Sustainability: Lessons for NSDL**

Kate Wittenberg

Will your digital resources and services survive and thrive? This was the central question driving the Ithaka Case Studies in Sustainability. We will hear from Kate Wittenberg, formerly with the NSDL Core Integration group and now the Project Director of Client and Partnership Development for Ithaka, as she walks us through options and obstacles facing projects such as NSDL.

1:00 pm**Meeting Adjourns**

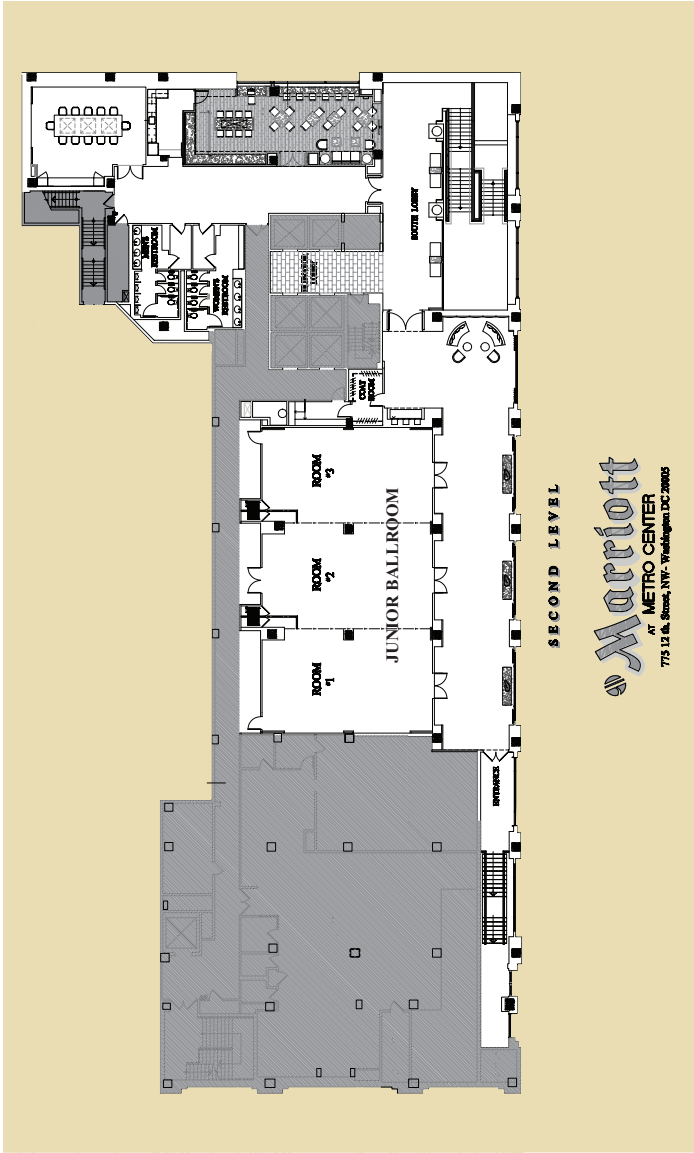

SECOND LEVEL

Marriott

AT METRO CENTER

775 12th St., S.W., Washington, D.C. 20005

